

- 16 Bayview Penthouses
- 32 Two Bedroom Garden Town Houses
- 10 Three Bedroom Town Houses
- 4 Courtyard Villas
- 62 Units in total

- Communal Swimming Pool
- Restaurant
- Clubhouse
- 24 Hour Security



## MASTER PLAN

Baan Yamu residences are a beautiful low density, residential community that blends in with the environment & maximizes sea views & privacy for all owners.



## EXECUTIVE VILLA



Baan Yamu Residences  
by Twinpalms



Built to customers' specifications, each villa would normally include 25m + infinity pool, 4m high ceilings in living/dining areas, extensive covered sea view terraces and ample accommodation for family and guests.

Clients may opt for in-house gyms, wine cellars, snooker/media rooms and underwater pool hi-fi, with Smart home, broadband wiring standard.

Areas vary between 450-800m<sup>2</sup> of internal space and 800m<sup>2</sup>-1600m<sup>2</sup> of outside living space excluding garden areas. Each unit stands on approx 1-2 rai (1,600 m<sup>2</sup>-3,200 m<sup>2</sup>) depending on villa size. Executive Villas are sold on a freehold basis.

Phase 1 is sold out and Phase 3 will offer 9 additional villas.

# EXECUTIVE VILLA

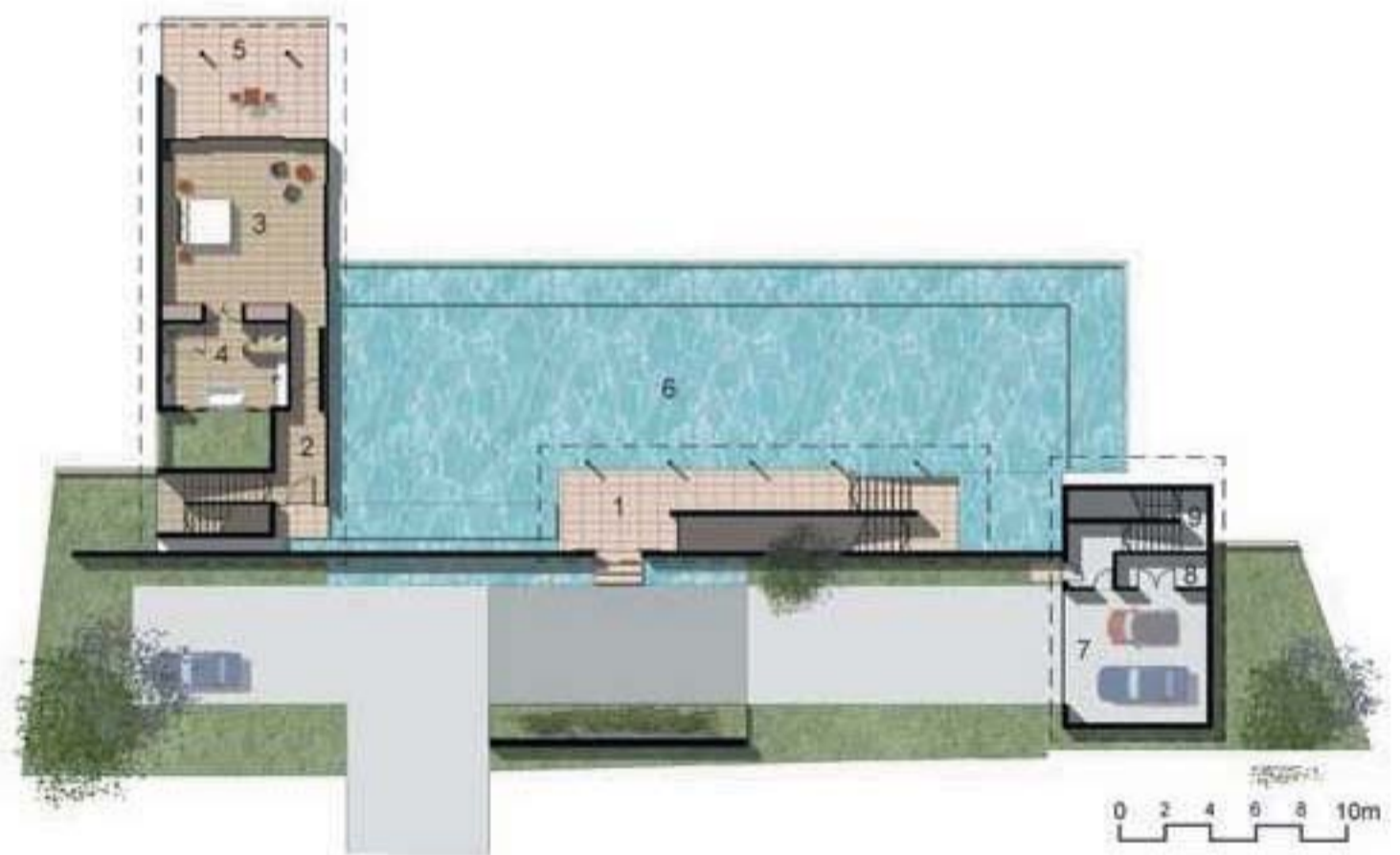

## EXECUTIVE VILLA

### Indoor

1 Entry Pavillion	60 m2
2 Gallery + Stairs	22 m2
3 Master Bedroom	44 m2
4 Ensuite	19 m2

### Outdoor

5 Balcony	35 m2
6 Shallow Reflection Pool	342 m2
7 Covered Garage	35 m2
8 Storage	6 m2
9 Stairs	15 m2

Indoor Total	603 m2
Outdoor Total	713 m2